



Speedline[®]
When fast is everything

When There's No Time to Spare.

Speedline delivers Weidmuller RockStar® Rectangular Connectors, FrontCom Adapters, and Cable Glands in commonly used sizes and configurations.

Make Your Last Minute Connections FAST!

If you need to make last minute connections fast, we can ship within 48 hours.*

Always In-Stock and Ready For You



Turnaround - No problem

- All products ship in 48 hours
- Guaranteed availability of commonly used products
- Assurance you'll have what you need for last minute requirements



Smart Packaging

- All components individually sealed
- HDC kits packaged and labeled in one bag
- All bulkheads have attached sealing gaskets (IP65)







We're Compatible

- Inserts and housings compatible with other manufacturers' products
- Go to www.weidmuller.com to download Weidmuller Galaxy Software for cross reference assistance

** All components in this brochure are available to ship within 48 hours of your order, excluding weekends and holidays. 48-hour shipping is not guaranteed for order quantities in excess of available stock or due to unforeseen circumstances. In these cases, Weidmuller will make every effort to fulfill your order.*



HDC KITS – with HA Inserts

SlimLine			Bulkhead Housing	Female Insert	Male Insert	Hood	Gland	
								
SlimLine HDC Kits				Kits Include These Components				
Screw-Clamp Part Number	Poles	Description	Inserts (Screw) Female Male	Bulkhead Part Number	Hood Part Number	Gland Part Number		
1712560000*	3 + Grnd	HA 3 Pin Kit, w/PG11 top entry, metal	F-1498200000 M-1498100000	1497600000	1652470000	1569080000		
1712570000	3 + Grnd	HA 3 Pin Kit, w/PG11 top entry, plastic	F-1498200000 M-1498100000	1652410000	1652380000	1568990000		
1712600000	4 + Grnd	HA 4 Pin Kit, w/PG11 top entry, plastic	F-1498400000 M-1498300000	1652410000	1652380000	1568990000		

HDC KITS – with HE Inserts

Standard				Bulkhead Housing	Female Insert	Male Insert	Hood	Gland
								
Standard HDC Kits				Kits Include These Components				
Screw-Clamp Part Number	Push-in Part Number	Poles	Description	Inserts (Screw) Female Male	Inserts (Push-in) Female Male	Bulkhead Part Number	Hood Part Number	Gland Part Number
1712460000	NEW	6 + Grnd	HE 6 Pin Kit, w/PG16 side entry, Alum.	F-1200200000 M-1200000000		1202100000	1652520000	1569100000
1712660000		6 + Grnd	HE 6 Pin Kit, w/PG16 top entry, Alum.	F-1498400000 M-1498300000		1202100000	1652640000	1569100000
1712510000		10 + Grnd	HE 10 Pin Kit, w/PG16 side entry, Alum.	F-1204100000 M-1203900000		1205000000	1654070000	1569100000
1712670000		10 + Grnd	HE 10 Pin Kit, w/PG16 top entry, Alum.	F-1204100000 M-1203900000		1205000000	1654220000	1569100000
1712520000	1027640000	16 + Grnd	HE 16 Pin Kit, w/PG21 side entry, Alum.	F-1207700000 M-1207500000	F-1873560000 M-1873570000	1208600000	1656480000	1569110000
1712680000	1061750000	16 + Grnd	HE 16 Pin Kit, w/PG21 top entry, Alum.	F-1207700000 M-1207500000	F-1873560000 M-1873570000	1208600000	1656590000	1569110000
1712530000	1061780000	24 + Grnd	HE 24 Pin Kit, w/PG21 side entry, Alum.	F-1211300000 M-1211100000	F-1873580000 M-1873590000	1212400000	1661230000	1569110000
1712690000	1061800000	24 + Grnd	HE 24 Pin Kit, w/PG21 top entry, Alum.	F-1211300000 M-1211100000	F-1873580000 M-1873590000	1212400000	1661370000	1569110000

Specifications	
UL/CSA Electrical Ratings:	600V/20A/20-14AWG
Material:	
Inserts:	Glass Fiber Reinforced Polycarbonate
Housings:	HA – Polyamide Plastic (IP65) HE – Diecast Aluminum Alloy (IP65)
Levers:	Stainless Steel
Temperature Range:	-40°C...125°C



HDC Assembly features:

- Protection class: IP65 and NEMA 4X
- Scratch resistant, corrosion proof housing plating
- Rust proof stainless steel levers and latching tabs
- Laser etched part numbers
- Pre-attached bulkhead gaskets

* Bulkhead Housing and Hood are metal; Glands are brass

For additional configurations, please contact your Weidmüller Sales Representative.

KVT Cabtite – Panel Feed Through Cable Management System



KVT Cabtite

Model	KVT 32 6G	KVT 32 8G	KVT 32 10G	KVT 32 2/6G	KVT 32 4/5G
Part Number	7940038584	7940038585	7940038586	7940038587	7940038588
Clamping Range:	4-5mm	8-9mm	10 - 11mm	2x6-7mm	4x5-6mm
Cut-Out Diameter	32mm(1.26")	32mm(1.26")	32mm(1.26")	32mm(1.26")	32mm(1.26")

Note: For larger variants, please contact your Weidmuller Sales Representative.

Specifications

Material/Color:	Polyamide 6 (UL94-V0)/Gray
Protection Class:	IP54
Temperature Range:	-5°C...70°C

Kit Contents (Example: KVT 32 2/6G)



Gland



Grommet



Sealing Rings



Locknut

HDC Inserts

SlimLine



Male



Female

HA Series - Inserts

Poles	Housing Size	Termination Type	SlimLine	
			Male Part Number	Female Part Number
3 + grnd	1	Screw	1498100000	1498200000
4 + grnd	1	Screw	1498300000	1498400000
10 + grnd	2	Screw	1650610000	1650620000
16 + grnd	5	Screw	1650770000	1650780000

HDC Housings

SlimLine



Bulkhead-End Locking



Hood-End Locking

HA Series - Compatible

Housing Size	Cable Entry/Size	Bulkhead Housing Part Number	Hood Housing Part Number
1	Top / PG11	1497600000	1652470000
1	Top / PG11	1652410000**	1652380000**
1	Side/ PG11	1497600000	1652480000
2	Top / PG16	1664040000	1663930000
2	Side/ PG21	1664040000	1663870000
5	Top / PG21	1664920000	1664870000
5	Side/ PG21	1664920000	1664750000

Standard



Male



Female

HE Series - Inserts

Poles	Housing Size	Termination Type	Standard	
			Male Part Number	Female Part Number
6 + grnd	3	Screw	1200000000	1200200000
10 + grnd	4	Screw	1204100000	1203900000
16 + grnd	6	Screw	1207500000	1207700000
24 + grnd	8	Screw	1211100000	1211300000

Specifications

UL/CSA Electrical Ratings:	600V/20A/20-14AWG
Material:	Glass Fiber Reinforced Polycarbonate
Temperature Range:	-40°C to +125°C

Standard



Bulkhead-Side Locking



Hood-Side Locking

HE Series - Compatible

Housing Size	Cable Entry/Size	Bulkhead Housing Part Number	Hood Housing Part Number
3	Top / PG16	1202100000	1652640000
3	Side/ PG16	1202100000	1652520000
4	Top / PG16	1206100000†	1655210000†
4	Top / PG21	1205000000	1654240000
4	Side/ PG21	1205000000	1654090000
6	Top / PG21	1208600000	1656590000
6	Side / PG21	1208600000	1656480000
6	Top / PG21	1210100000†	1657960000‡
6	Side / PG21	1209700000‡	1657850000‡
8	Top / PG29	1212400000	1661380000
8	Side/ PG29	1212400000	1661240000
8	Top / PG21	1214300000†	1662540000‡
8	Side / PG21	1213900000‡	1662390000‡

** Bulkhead and Hood Housings are plastic

† End locking w/cover

‡ End locking

For additional configurations, please contact your Weidmuller Sales Representative.

Cable Glands & Adapters

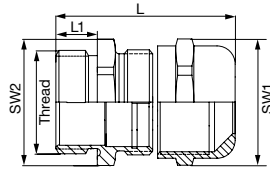

Cable Glands, Metal - IP68

Type metric	Thread-size	Wire Range-dia (mm)	L/L1 (mm)	SW1/SW2 (mm)	Part Number
VG 11-MS68	PG 11	5 - 10	28.5 / 6	20	1569080000
VG 13.5-MS68	PG 13.5	6 - 12	29.5 / 6.5	22	1569090000
VG 16-MS68	PG 16	10 - 14	29.5 / 6.5	24	1569100000
VG 21-MS68	PG 21	13 - 18	33.5 / 7	30	1569110000
VG 29-MS68	PG 29	18 - 25	37.5 / 8	40	1569120000

Specifications

Material:	Brass, nickel-plated
Temperature Range:	-20°C...60°C
Protection:	IP68

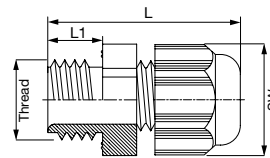

Cable Glands, Plastic - IP68

Type metric	Thread-size	Wire Range-dia (mm)	L/L1 (mm)	SW (mm)	Part Number
VG 11-K68	PG 11	5 - 10	37 / 8	22	1568990000
VG 13.5-K68	PG 13.5	6 - 12	39 / 9	24	1569000000
VG 16-K68	PG 16	10 - 14	42.5 / 10	27	1569010000
VG 21-K68	PG 21	13 - 18	48 / 11	33	1569020000
VG 29-K68	PG 29	18 - 25	53 / 11	42	1569030000

Specifications

Material/Color:	Polyamide 6/White
Temperature Range:	-30°C...80°C
Protection:	IP68

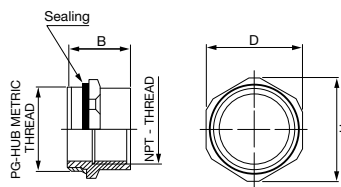

Cable Adapters - PG to NPT

Type	Thread-size	NPT	B (mm)	H (mm)	D (mm)	Part Number
PG 16/NPT 1/2"	PG 16	1/2"	22.8	29.2	27	1712360000
PG 21/NPT 3/4"	PG 21	3/4"	25	35.2	32	1712370000
PG 29/NPT 1"	PG 29	1"	30	43.5	40	1712390000
PG 36/NPT 1 1/4"	PG 36	1 1/4"	32	55	50	1712380000

Specifications

Material:	Brass, nickel-plated
Temperature Range:	-40°C...100°C
Protection:	IP54



FrontCom Panel Feed-through Adapter - RJ & USB

Model	Description	Part Number
FCM-RJ45-C	RJ45 through panel	1018790000
FCM-USB-A	USB-Type A through panel	1018840000

Specifications

Category:	Cat. 6A/Class E
Material:	Polyamide 6 (UL94-V0)
Temperature Range:	-30°C...80°C
Protection:	IP65

HDC Panel Cut-out Dimensions

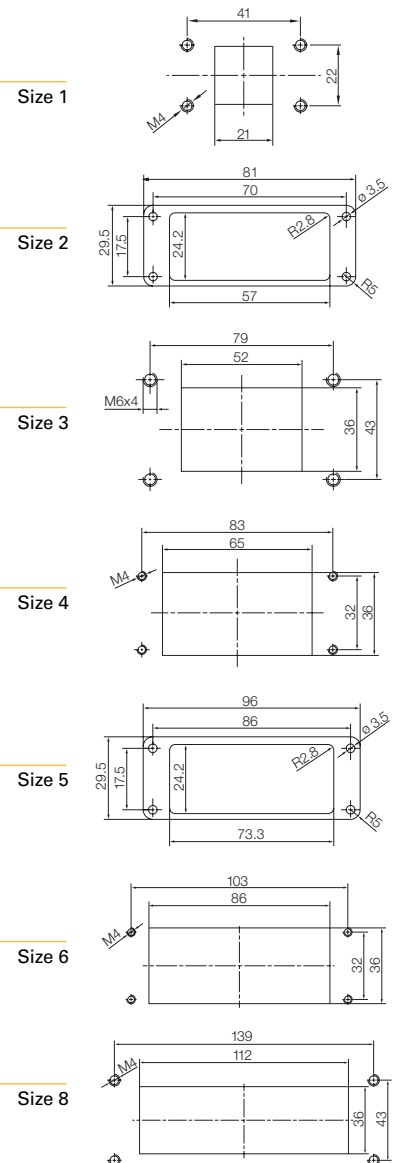

For additional configurations, please contact your Weidmuller Sales Representative.

Argentina
Australia
Austria
Azerbaijan
Bahrain
Belarus
Belgium
Bosnia-
Herzegovina
Brazil
Bulgaria
Canada
Chile
China
Colombia
Costa Rica
Croatia
Czech Republic
Denmark
Ecuador
Egypt
Estonia
Finland
France
Germany
Greece
Hong Kong
Hungary
Iceland
India
Indonesia

Iran
Ireland
Israel
Italy
Japan
Jordan
Kazakhstan
Kuwait
Latvia
Lebanon
Lithuania
Luxembourg
Macedonia
Malaysia
Malta
Mexico
Montenegro
Netherlands
New Zealand
Norway
Oman
Paraguay
Peru
Philippines
Poland
Portugal
Qatar
Romania
Russia
Saudi Arabia
Serbia

Singapore
Slovakia
Slovenia
South Africa
South Korea
Spain
Sweden
Switzerland
Syria
Taiwan
Thailand
Turkey
UAE
Ukraine
United Kingdom
Uruguay
USA
Venezuela
Vietnam
Yemen

Weidmuller is the leading manufacturer of components for electrical connection technology to transmit energy, signals and data. The Weidmuller product portfolio ranges from terminal blocks, PCB connectors and terminals, protected components, Industrial Ethernet components, I/O components and relay sockets to power supplies and overvoltage protection modules suitable for all applications. Assemble Services, marking solutions with a variety of tools and software systems, round off the range. As an OEM supplier, the company sets global standards in the field of electrical connection technology.

Weidmuller, Canada
10 Spy Court
Markham, Ontario L3R 5H6
Telephone: (800) 268-4080
Facsimile: (877) 300-5635
Email: info1@weidmuller.ca
Website: www.weidmuller.ca

Weidmuller, Mexico
Blvd. Hermanos Serdán 698,
Col. San Rafael Oriente
Puebla, Puebla, Mexico
C.P. 72029
Telephone: 01 222 2686267
Facsimile: 01 222 2686219
Email: clientes@weidmuller.com.mx
Website: www.weidmuller.com.mx

Weidmuller, United States
821 Southlake Blvd.
Richmond, Virginia 23236
Telephone: (800) 849-9343
Facsimile: (804) 379-2593
Email: info@weidmuller.com
Website: www.weidmuller.com